



CTS[®]
COMBINED
TACTICAL SYSTEMS

TEC Torch[®]

THERMAL BREACHING

A Thermal Erosion Cutting torch has never been so small and so fast.

- TEC Torch[®] combines thermal energy and mechanical erosion to quickly defeat a variety of obstacles
- Cuts up to 3/4" steel rod on locks, chains, rebar, and cables
- Penetrates up to 1/2" steel plating
- Fast, up to 4,000°F in 1-2 seconds
- Thermite based composition optimized for maximum cutting power
- Portable, compact, lightweight
- Low noise, non-explosive
- Accessories are available for remote mounting, remote firing and multiple cartridge firing
- Designed for underwater use

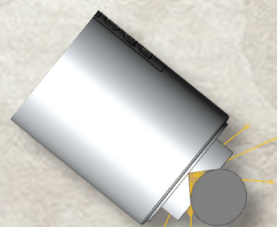

C112 Rod Cutter

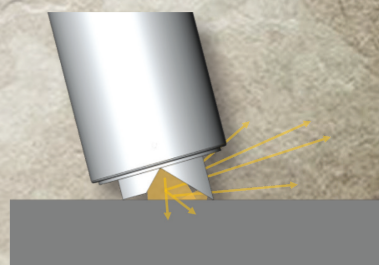

C212 Plate Penetrator